

MASTER PLAN

TATISILWAI INDUSTRIAL PHASE - 1, RANCHI

IN . HACTARE / ACRE

- 1.TOTAL LAND AREA → 59.110 ACRE
- 2.ADMINISTRATIVE AREA →
- 3.COMMON FACILITY AREA → 10.745 ACRE
- 4.NET INDUSTRIAL AREA → 48.365 ACRE
- 5.OTHER AREA → NIL

CATEGORY

- HAZARDOUS /POLLUTING
- NON HAZARDOUS/NON POLUTING
- MIXED - YES

A

INTERNAL INFRASTRUCTURE

- POWER POLE / SUBSTATION - YES
- ICT--- PROP
- STP - NO
- CETP - NO
- WATER SUPPLY/ WATER TREATMENT - YES
- STROM WATER DRAINAGE /COVERED - OPENED - YES
- RUN OFF USED FOR RAIN WATER HARVESTING - NO
- ROADS - YES

B

EXTERNAL INFRASTRUCTURE

- LOGISTIC TERMINAL - 500M
- POWER SUB STATION - 1 KM
- SOLID WASTE DISPOSAL/ TREATMENT SITE - 25 KM
- BUS STOP - 0 KM
- RAIL - 500 M
- PORTS - MAPED WITH GIS
- AIR PORTS - 15 KM

C

COMMON FACILITY

- COMMON FACILITY CENTER
- DORMITORY FOR LABOUR / DRIVER
- BANK BRANCH /ATM
- CANTEEN / RESTORENT
- WEIGH BRIDGE FOR CARGO/FREIGHT
- TRUCK PARKING
- SKILL DEVELOPMENT CENTER
- CFC - (ADMINISTRATION AREA, COMMON FACILITY AREA)

D.

SAFTY

- FIRE SAFTY
- AIR QUALITY MONOTRING STATION
- SETUP IN PHASE II

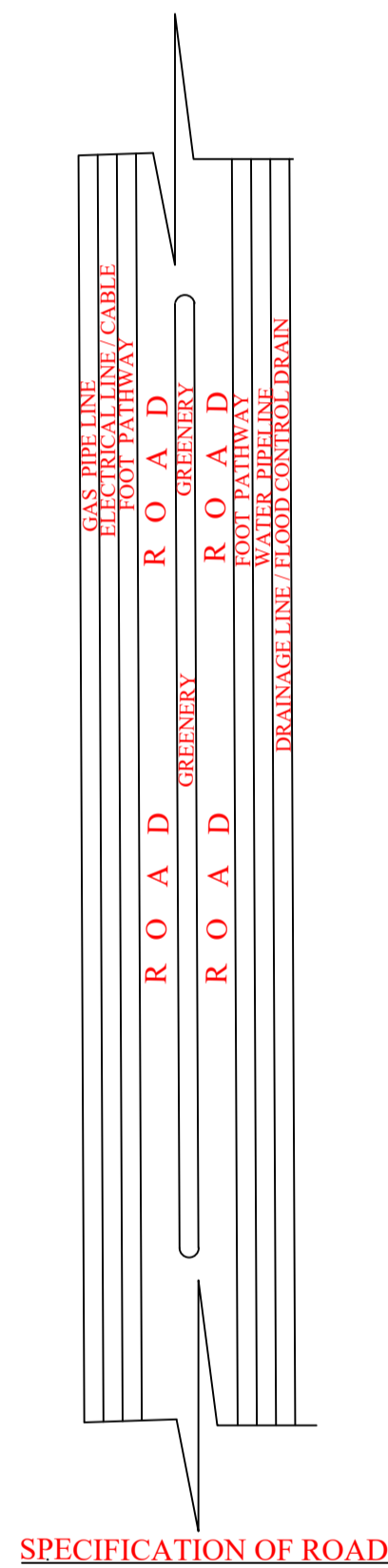
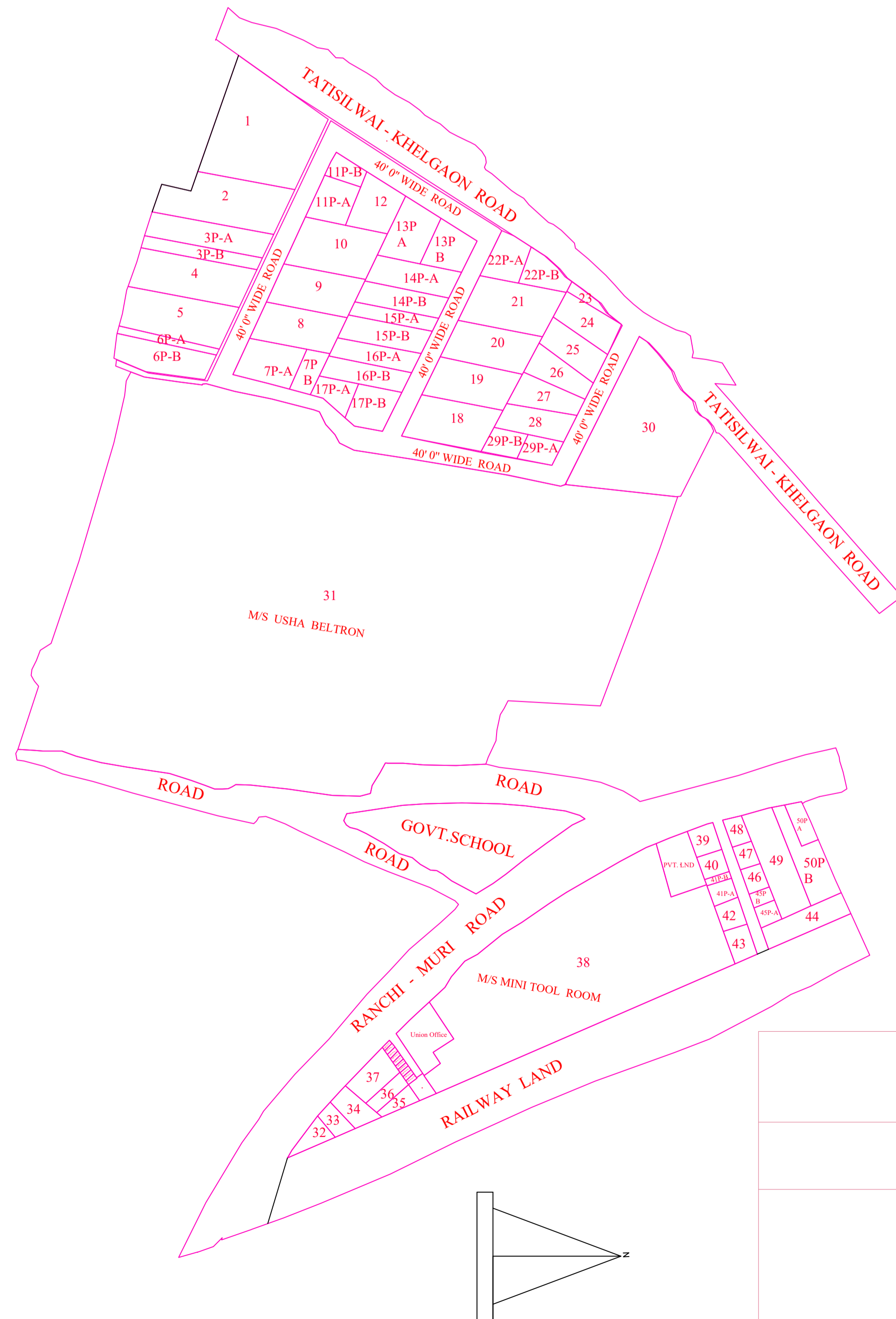

SPECIFICATION OF ROAD

NOTES: -

SEGMENT WISE DETAILS OF PLOT	PLOT SIZE
1. CHEMICAL / FERTILIZER	<input type="checkbox"/>
2. AUTOMOBILE	<input type="checkbox"/>
3. ELECTRONIC ITEM.	<input type="checkbox"/>
4. FOOD INDUSTRIES	<input type="checkbox"/>
5. GENRAL PLASTIC ITEM	<input type="checkbox"/>
6. TEXTILE INDUSTRES	<input type="checkbox"/>
7. WERE HOUSING AND LOGISTIC.	<input type="checkbox"/>
8. IT/ COMPUTER INDUSTRES.	<input type="checkbox"/>
9. FABRICATION AND JOB WORK.	<input type="checkbox"/>
PLOT STATUS.	
1. ALLOTED.	<input type="checkbox"/>
2. VACANT.	<input type="checkbox"/>
3.INPRODUCTION.	<input type="checkbox"/>

JHARKHAND INDUSTRIAL AREA DEVELOPMENT
AUTHORITY, RANCHI REGION
TATISILWAI INDUSTRIAL PHASE - 1, RANCHI